

A . Features

- Radio-controlled signal received by watch hands.
- Radio-controlled signal receiving frequency: 77.5KHz (DCF single frequency)
- The watch will receive the time signal automatically at 3:00 a.m. everyday.

B . Product Function Modes

1. Three hands must be calibrated after replacing the battery or resetting.

- Please replace the battery when it has run out.
- Second hand stops running after module initialization, at this time, analog doesn't work. If three hands don't point to 12 o'clock, please adjust the hands according to below steps.
- Press A button once to make second hand advance 1 second clockwise, hold down A for long time to fast adjust the second hand so that it points to 12 o'clock.
- Pull out the crown, then rotate the crown to make "hour hand" and "minute hand" point to 12 o'clock.
- Push in the crown, hold down B for 2 seconds to enter radio -controlled signal receiving screen. If without signal, the system will automatically initialize after signal reception fails.

2. To receive RCC manually

- In Regular Timekeeping Mode, hold down A button for 2 seconds to receive time signal manually. Second hand points to (4 o'clock) and stops running, please see below figure:

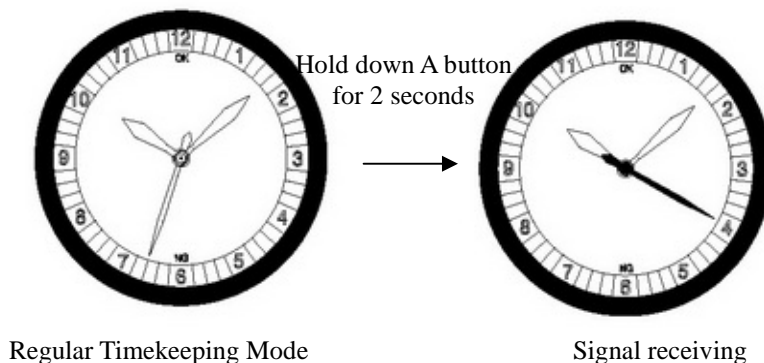

- 4 minutes later, signal reception is successful: Three hands (hour hand, minute hand and second hand) automatically calibrate the time and make the time is synchronized with signal transmitted station.
- In signal receiving state, shortly press A or B button to stop receiving, the watch runs system time automatically. (If hands still in stopped state after pressing A or B button, in this situation, you should wait for 1 minute until hands automatically run.).

Remark: If the watch always fails to receive the signal, the watch will automatically stop receiving in 1 minutes.

- And if signal is weak or no signal, it will stop receiving automatically in 5 minutes. Three hands (hour hand, minute hand, second hand) will automatically recover the original time.

3. To receive RCC automatically

- The module will turn on frequency automatically to receive calibration signal at 3:00 a.m. everyday, if failed to receive, frequency will be turned on automatically to receive calibration signal at 4:00 a.m. again, if failed, it will be turned on automatically to receive radio signal at 5:00 again, and if failed again, it will stop receiving on that day, and will not start to receive until the next day at 3:00 a.m.. If received successfully at 3:00 a.m., it will not receive at 4:00 a.m. and 5:00 a.m.

4. To view the signal reception is successful or not

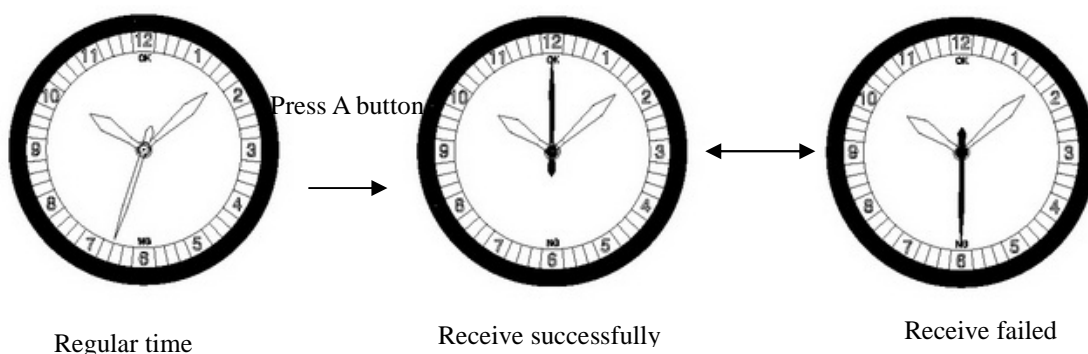

- In Regular Timekeeping Mode, press A to view the signal reception is successful or not in 24 hours. Second hand points to “OK”that means signal reception is successful, on the contrary, if it points to “NG” that is fail.
- During viewing the signal reception, hand will stop running for 5 seconds. Press A or B to exit from View Mode (If hands still in stopped state after pressing A or B button, in this situation, you should wait for 1 minute until hands automatically run.).

5. Signal initializing reception (To calibrate the hands when the time is incorrect during normal usage.)

- In Regular Timekeeping Mode, pull out the crown, second hand stops running after it fast points to 12 o'clock. If second hand doesn't point to 12 o'clock, you can press A button once to make second hand advance 1 second clockwise, hold down A for long time to fast adjust the second hand so that it points to 12 o'clock. Then rotate the crown to make “hour hand ” and “minute hand” point to 12 o'clock.

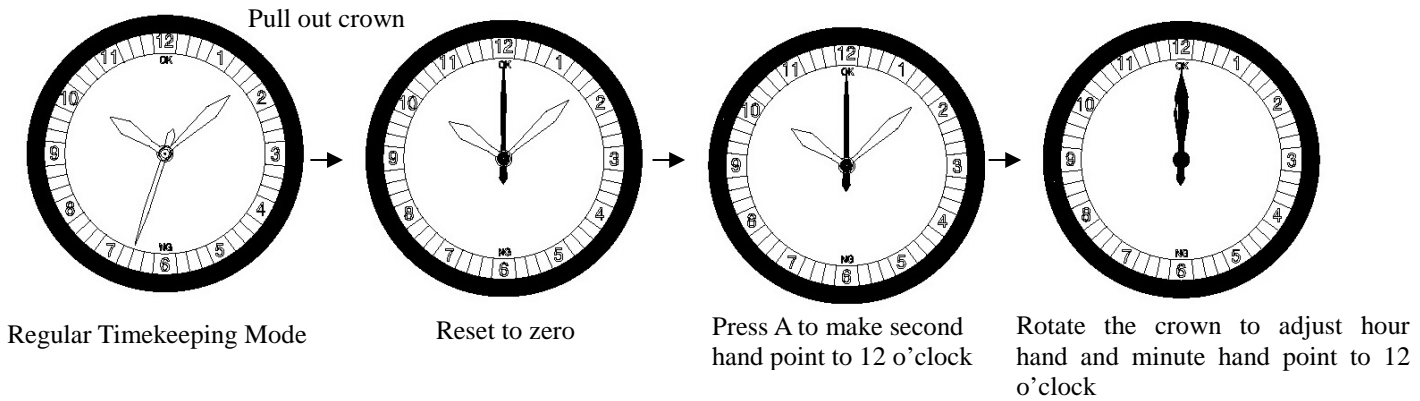

- Push in the crown after three hands point to 12 o'clock.
- Hold down B for 2 seconds to enter signal reception screen. If signal reception is successful, three hands (hour hand, minute hand and second hand) automatically calibrate the time and make the time is synchronized with signal transmitted station.

Notes: 1) When the watch enters resetting screen, and the crown doesn't push in, in such case, the watch will not receive the signal even though you hold down B button for long time.

2) Please do not pull out the crown freely during the watch is using.

6. Time setting (Please according below steps to adjust the time when the area without signal service)

- In Regular Timekeeping Mode, hold down B for 6 seconds, second hand stops running after it fast points to 12 o'clock. If second hand doesn't point to 12 o'clock, you can press A button once to make second hand advance 1 second clockwise, hold down A for long time to fast adjust the second hand so that it points to 12 o'clock. Then pull out the crown and enter "Hour" setting screen, please see below figures:

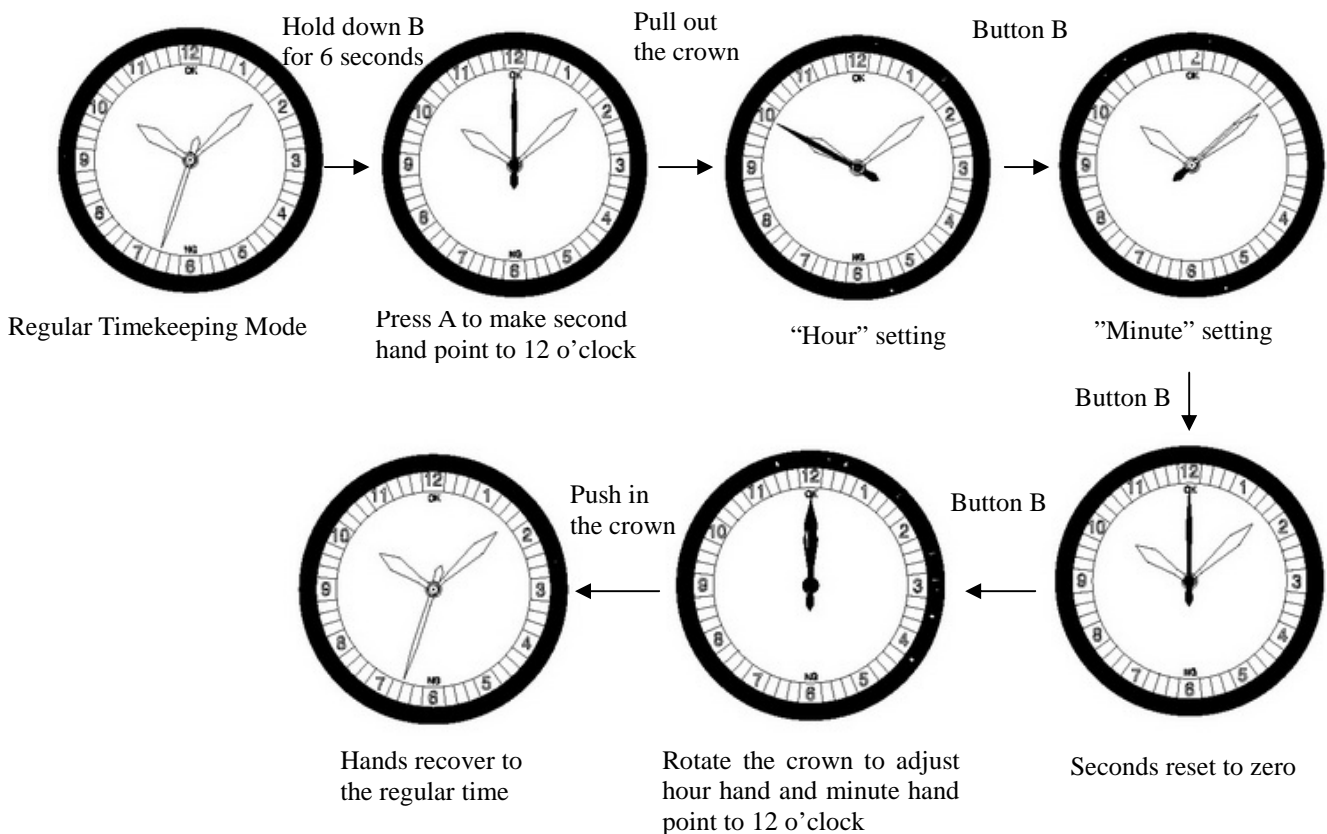

- To set the hour: Press A once, second hand fast run 5 steps, which is equivalent to an hour.
- To set the minute: Press A once, second hand advances 1 step, which is equivalent to a minute. Hold down A to fast adjust, and release A to stop adjusting.
- After minute is set, press B to make second hand point to 12 o'clock, at this time, you must use the crown to adjust hour hand and minute hand point to 12 o'clock
- Push in the crown, three hands (hour hand, minute hand, second hand) will automatically recover the regular time.

Note:

The preset time is one minute (or more than 1 minute) faster than standard time. After three hands point to 12 o'clock, please push in the crown once the standard time runs to the preset time, which means operation is completed. For example: The current standard time is 6:30:12, you should set it to be 6:31, then the seconds resets to zero and second hand points to 12 o'clock. Rotate the crown to adjust hour hand and minute hand also point to 12 o'clock, at this time, you should not push in the crown until the time runs to 6:31:00

- 2) **If the crown has been pulled out, you should press B to set hour and minute, after this, push in the crown, three hands (hour hand, minute hand, second hand) will automatically recover the regular time.**
- 3) **In setting mode, if you do not perform any button within one minute when the crown has been pulled out, the watch will automatically return to regular time.**
- 4) **Please do not pull out the crown freely during the watch is using.**

C. Instruction for assembling the hands

- Use a metal stick to touch the reset (AC), then assemble hour ,minute, second hands, and must keep three hands point to 12 o'clock. After this, hold down B for 2 seconds to automatically enter signal reception screen.

F. The requirements for matching the watchcase

- If use steel back case, we advise to match with rubber dial plate or paster dial plate
- To assure better signal, we advise to use glass back case and paster dial plate.

G. Specifications

- Module dimension : Φ 33.mm
- Module thickness : 7.0±0.15 mm
- Working temperature range : -10°C~+60°C
- Working voltage : 3.0V
- Time accuracy : ±60 sec/month
- Battery code and capacity : CR2032(Capacity:220m Ah)
- Static average driving current : ≤3.29u A (Static maximum driving current: ≤12 u A)
- Maximum current for signal reception : ≤70 u A
- Sensitivity of RCC reception(only module) : ≤45dBuv/m (≤180 u V/m)
- Battery life (To receive signal once (5 minutes) per day) : ≥ 7 years (Japanese battery)